

N20/30

FF030

RF130

BLDC
1632

FF130

FF180

RF500

RF300

RF310

094

BLDC
2035

370

2418

2430

385

2838

395

30-C

32-C

40-C

32ZY13

32ZY25

520

BLDC
520

380

555

BLDC
3640

775

38S

BLDC
38S

45S

BLDC
45S

50S

BLDC
50S

60S

BLDC
60S

80S

稳压器

同步
电机永磁
直流电机交流
可逆电机

ZGB60FM-G(A8044)



Dimension(mm)

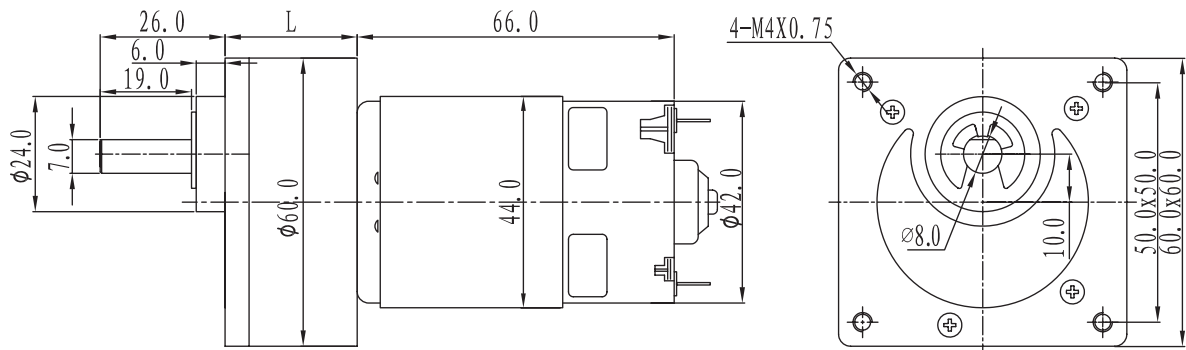

Specifications

DC Motor	Ratio	1/18.8	1/23.6	1/27.8	1/62	1/78	1/91.9	1/205	1/257	1/303	1/1000
ZYTD-555 (12V-3700R)	No load (r/min)	190	150	130	57	46	39	17	14	12	3
	On load (r/min)	160	125	105	49	40	35	16	13	11	3
	Rated torque (kgf.cm)	5	6.3	8.6	15	15	15	20	20	20	25
ZYTD-555 (24V-5300R)	No load (r/min)	255	205	170	77	61	52	23	19	16	5
	On load (r/min)	215	170	145	70	56	49	22	18	15	5
	Rated torque (kgf.cm)	7.8	9.8	12	15	15	15	20	20	20	25
Direction	电源正极接 + 端子	CW			CCW			CW			CCW

Gearbox

Reduction Ratio	L	Stages	Allowable torque	
	mm		mN.m	kgf.cm
1/18.8~1/27.8	34	3	1176	12
1/62~1/91.9	36.5	4	1470	15
1/205~1/303	40.5	5	1960	20
1/1000	45.7	6	2450	25

★ Other specification can be customized.