

# ZGB25RQ(A4049)

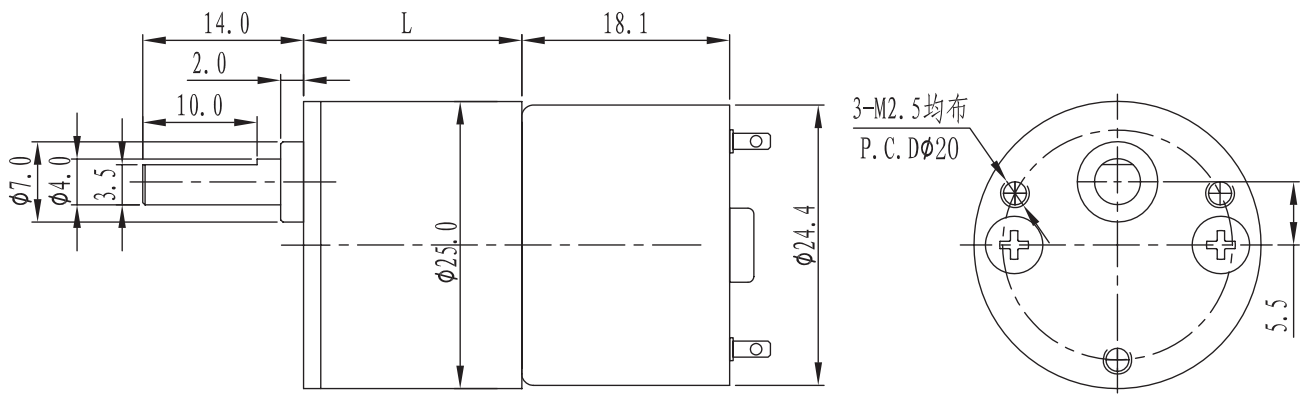

## Dimension(mm)



## Specifications

DC Motor	Ratio	1/5.7	1/10.6	1/14.7	1/23.4	1/32	1/51.5	1/71	1/98	1/113	1/133	1/184	1/216	1/253	1/293	1/344	1/404	1/474
ZYTD-RF310 (6V-4000R)	No load (r/min)	720	390	280	175	130	80	58	42	36	31	23	19	16	14	12	10	9
	On load (r/min)	560	300	220	135	100	62	45	32	28	24	17	15	12	11	9	8	7
	Rated torque (gf.cm)	25	40	55	80	110	160	220	310	320	380	520	620	720	750	890	1000	1200
ZYTD-RF310 (12V-5000R)	No load (r/min)	930	500	360	225	165	100	75	54	47	40	29	24	21	18	15	13	11
	On load (r/min)	730	400	285	180	130	80	60	43	37	31	23	19	17	14	12	10	9
	Rated torque (gf.cm)	30	55	75	110	150	220	300	415	430	510	700	825	970	1000	1200	1400	1600
Direction	电源正极接 + 端子	CCW	CW	CCW				CW				CCW					CW	

## Gearbox

Reduction Ratio	L	Stages	Allowable torque	
	mm		mN.m	gf.cm
1/5.7	19	3	59	600
1/10.6~1/14.7	19	4	78	800
1/23.4~1/32	19	5	98	1000
1/51.5~1/98	22	6	147	1500
1/113~1/253	24	7	245	2500
1/293~1/474	27	8	245	2500

★ Other specification can be customized

N20/30  
FF030  
RF130  
BLDC 1632  
FF130  
FF180  
RF500  
RF300  
RF310  
094  
BLDC 2035  
370  
2418  
2430  
385  
2838  
395  
30-C  
32-C  
40-C  
32ZY13  
32ZY25  
520  
BLDC 520  
380  
555  
BLDC 3640  
775  
38S  
BLDC 38S  
45S  
BLDC 45S  
50S  
BLDC 50S  
60S  
BLDC 60S  
80S  
稳压器  
同步电机  
永磁直流电机  
交流可逆电机