

N20/30

FF030

RF130

BLDC
1632

FF130

FF180

RF500

RF300

RF310

094

BLDC
2035

370

2418

2430

385

2838

395

30-C

32-C

40-C

32ZY13

32ZY25

520

BLDC
520

380

555

BLDC
3640

775

38S

BLDC
38S

45S

BLDC
45S

50S

BLDC
50S

60S

BLDC
60S

80S

稳压器

同步
电机永磁
直流电机交流
可逆电机

ZGA25RQ(A4049)



Dimension(mm)

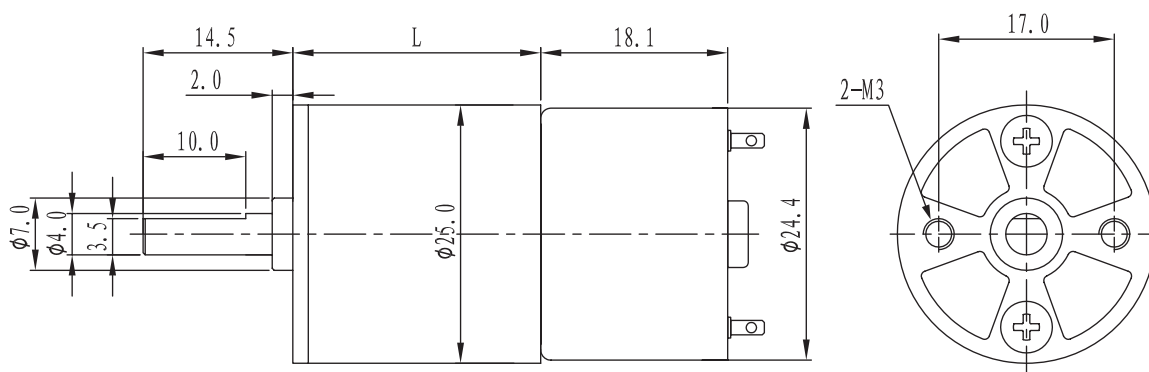

Specifications

DC Motor	Ratio	1/4.8	1/10.6	1/14.7	1/27.5	1/32	1/51.5	1/71	1/98	1/113	1/156	1/216	1/293	1/404	1/474	1/654
ZYTD-RF310 (6V-4000R)	No load (r/min)	865	390	285	150	130	80	60	43	37	27	20	14	10.5	9	6.5
	On load (r/min)	675	305	220	120	100	65	45	33	29	21	15	11	8	7	5
	Rated Torque (gf.cm)	20	45	65	110	125	180	250	350	360	500	700	840	1150	1350	1850
ZYTD-RF310 (12V-5000R)	No load (r/min)	1100	500	360	190	165	100	75	54	47	34	24	18	13	11	8
	On load (r/min)	875	400	285	150	130	80	60	43	37	27	19	14	10	9	6.5
	Rated torque (gf.cm)	30	60	100	145	170	240	335	460	480	660	920	1100	1550	1800	2500
Direction	电源正极接 + 端子	CW	CCW	CW			CCW		CW		CCW					

Gearbox

Reduction Ratio	L	Stages	Allowable torque	
	mm		mN.m	gf.cm
1/4.8	19	2	59	600
1/10.6~1/14.7	19	3	78	800
1/27.5~1/32	19	4	98	1000
1/51.5~1/98	22	5	147	1500
1/113~1/216	24	6	245	2500
1/293~1/654	27	7	245	2500

★ Other specification can be customized.

025

浙江正科电机有限公司 Tel:0577-6289 0088

Fax:0577-6287 1122

Http:www.zhengkemotor.com